

Plan Information

| | |
|--------------|----------------|
| Tenure Type | Freehold |
| Plan Type | Deposited Plan |
| Plan Purpose | Subdivision |

Plan Heading

Subdivision of Lot 202

Locality and Local Government

| | |
|------------------|-------------------|
| Locality | BAYSWATER |
| Local Government | CITY OF BAYSWATER |

Planning Approval

| | |
|--------------------|--------|
| Planning Authority | WAPC |
| Reference | 156799 |

Roads

| | |
|---|----|
| Private Road or Private Right of Way Acquired | No |
| Road Closure Action | No |
| New Road or Road Extension Created | No |
| Road Name Approval Exemption | No |

Survey Details

| | |
|----------------------------|---------------------|
| Survey Method | Conventional Survey |
| Field Records | 144112 |
| Declared as Special Survey | No |

Survey Certificate - Regulation 54

I hereby certify that this plan is accurate and is a correct representation of the:
 (a) * survey; and/or
 (b) * calculations and measurements;
 [* delete if inapplicable]
 undertaken for the purposes of this plan and that it complies with the relevant written law(s) in relation to which it is lodged.

| | |
|-------------------------|------|
| BRADLEY ROBERT MCGREGOR | Date |
| Licensed Surveyor | |

Survey Organisation

| | |
|-----------|--------------------------|
| Name | MCGREGOR SURVEYS PTY LTD |
| Address | WEST PERTH 6005 |
| Phone | (08) 9322 2000 |
| Fax | |
| Email | |
| Reference | 175-849 |

Former Tenure

| New Lot / Land | Parent Plan Number | Parent Lot Number | Title Reference | Parent Subject Land Description |
|----------------|--------------------|-------------------|-----------------|---------------------------------|
| 100-101, 301 | P2703 | LOT 202 | 486-87A | |

Former Tenure Interest and Notifications

| Subject | Former Tenure | Action | Lots On This Plan | Origin | Endorsement | Comments |
|---------|---------------|---------------------------|-------------------|--------|--|------------------------------------|
| | 202/P2703 | Brought forward (in full) | LOTS 100-101 | P6010 | EASEMENT BENEFIT FOR RIGHT OF CARRIAGEWAY PURPOSES SEE SECTION 167A T.L.A. AND PLAN 2703 (SHEET 9) | Easement benefit to Lot 100 & 100. |

Vesting Lots

| Land | Purpose | Statutory Reference | Origin | Comments |
|---------|--------------|------------------------------|-----------|----------|
| LOT 301 | RIGHT OF WAY | SEC. 152 OF THE P&D ACT 2005 | THIS PLAN | |

 ADDITIONAL SHEETS
 ENDORSEMENT SHEET

 SHEET
 1 OF 2

 VERSION NUMBER
 1

 DEPOSITED PLAN
 414748

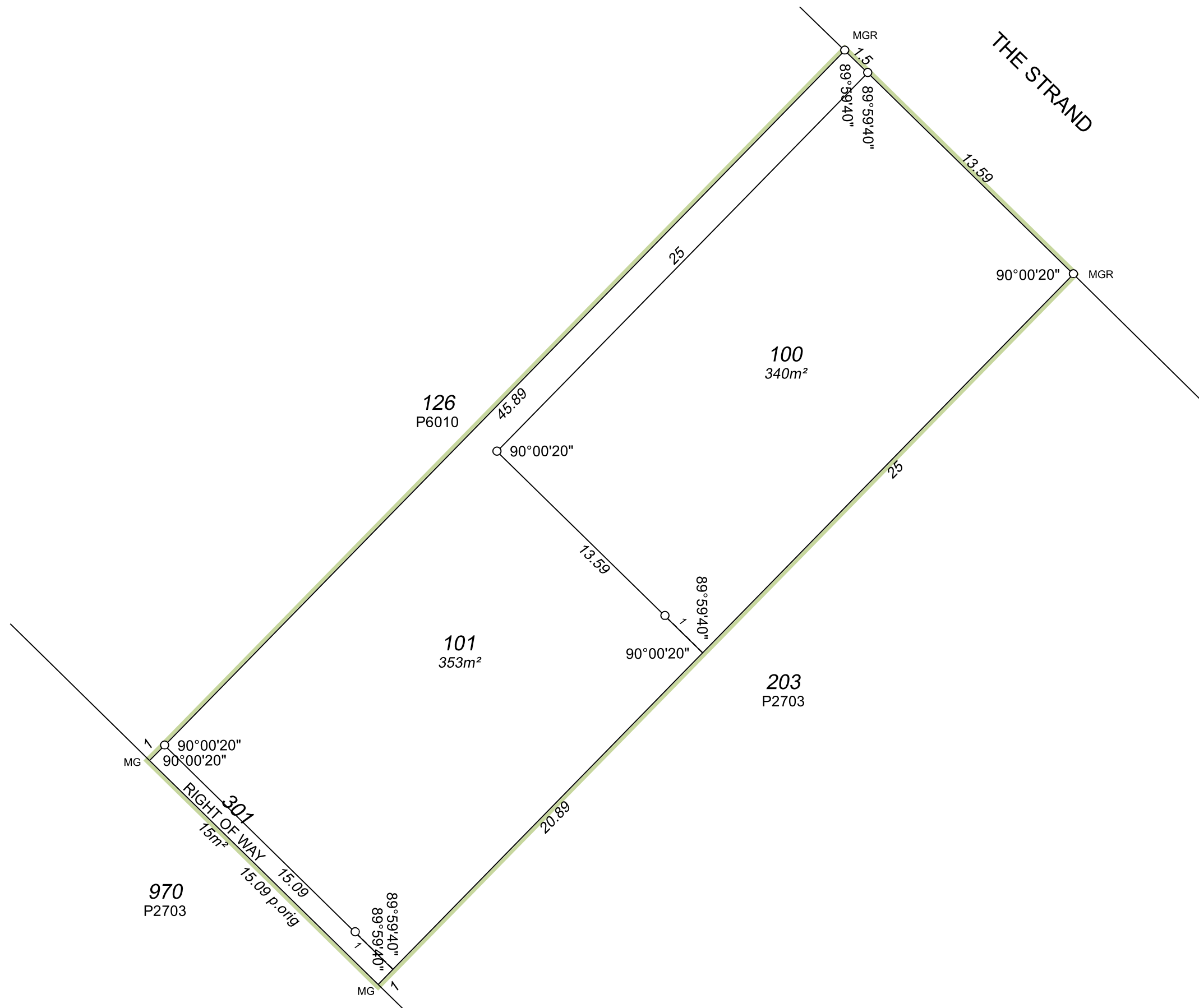

SCALE 1:200 @ A3
 2 0 10
 ALL DISTANCES ARE IN METRES



ADDITIONAL SHEETS
 ENDORSEMENT SHEET

SHEET 2 OF 2 SHEETS

VERSION NUMBER 1

DEPOSITED PLAN 414748